

PB-9250J-110V

9250 watt seconds standalone supercapacitor-based UPS modul for railway applications

Features

- › Universal standalone power backup module compatible with all box PCs
- › Supports 43-160V wide-range DC input for railway application
- › 9250 watt-second energy capacity
- › Maximum 120W output power for the connected back-end system
- › Over 10 years lifespan, or 500,000 charge/ discharge cycles
- › Patented CAP energy management technology (*R.O.C Patent No. I598820*)
- › EN 50155 and EN 45545 certificate
- › -40 to 70°C operation for EN 50155 OT4 class conformity

BRAND-NEW



High-energy SuperCAP UPS for railways

PB-9250J-110V is a newly designed SuperCAP UPS accepting 110V DC input for fast-growing railway applications. Composed with eight 370F supercapacitor, it provides 9250 watt-second stored energy to sustain back-end system from seconds to minutes during power loss. Different from traditional battery-based UPS systems, supercapacitor has a wide operating temperature range and long operating life up to 10 years. PB9250J-110V features -40 to 70°C operating temperature range and extremely high durability.

Thanks to its patented CAP energy management technology, PB-9250J-110V provides sophisticated features such as real-time energy/ power consumption monitoring, high/low voltage protection, and auto/ manual shutdown control. It automatically manages boot and shutdown to help your system thrive on trains with unstable power source. Additional digital output channels are incorporated for indicating system status such as charging/ discharging and power button control.

While computer systems are widely deployed in various railway applications, the rolling stock's electrical stability still remains a focal point and is crucial for system reliability. PB-9250J-110V can protect the computer or other equipment against power interruption when a train passes through a level crossing or a railroad switch. Furthermore, with its EN 50155 and EN 45545 certificate, PB-9250J-110V can be easily installed and implemented with existing computer/equipment or integrated with onboard power distribution system.



PB-9250J-110V

9250 watt seconds standalone supercapacitor-based UPS modul for railway applications

PB-9250J-110V

SUPERCAPACITOR CONFIGURATION

Composition	8x 370F, 3.0V supercapacitors
Capacity	9250 watt-second
Expected Lifespan	>10 years*
Lifecycle	500,000 charging/ discharging cycles*

POWER SPECIFICATION

Input Voltage	43-160 VDC
Input Connector	1x 3-pin pluggable terminal block (V+, GND)
Output Voltage	24 VDC
Output Power	Maximum 120W output
Output Connector	1x 3-pin pluggable terminal block (V+, GND)

I/O INTERFACE

COM Port	1x DB9 for 3-wire isolated RS-232
Isolated DIO	1x 10-pin pluggable terminal block for - ATX mode PWR_BTN# output (open-drain, pulse type) - AT mode PWR_BTN output (open-drain, level type) - DISCHARGING ALERT output (open-drain, level type) - SYS_STAT input

MECHANICAL

Dimensions	110mm (W) x 175.2mm (H) x 128.2mm (D)
Weight	2.33 kg
Mounting	DIN-rail mounting or optional wall-mounting
Operating temperature	-40°C ~ 70°C EN50155 OT4 class
Storage temperature	-40°C ~ 85°C
Vibration	Compliant with IEC61373:2010, Category 1, Class B Body mounted (part of EN50155)
Shock	Compliant with IEC61373:2010, Category 1, Class B Body mounted (part of EN50155)
EMC	EN 50155:2017, Clause 13.4.8 CE/FCC Class A, according to EN 55032 & EN 55035
EN50155	All mandatory sections of EN 50155:2017
EN45545	EN 45545-2 (Fire protection on railway vehicles)

*To achieve > 10 years lifespan under 24/7 at 70°C operation, please charge PB-9250J-SA to 6525J energy level using the 4.8x SuperCAP Lifetime Extension setting (please refer to the user manual for details). Once the rated lifetime or cycle life has been reached, the capacity of supercapacitor may decrease up to 30% and ESR may increase up to 100% from initial values.

** Backup time for uninterruptible operation may be reduced when sustaining a back-end system with high power consumption. Please consult with Neosys Technology if your computer accepts only constant-voltage input.

*** To ensure PB-9250J's power backup operation functions as intended, please contact Neosys Technology technical support if your connecting back-end system accepts only constant voltage input.

PB-9250J-110V

9250 watt seconds standalone supercapacitor-based UPS modul for railway applications

Appearance and dimensions (mm)

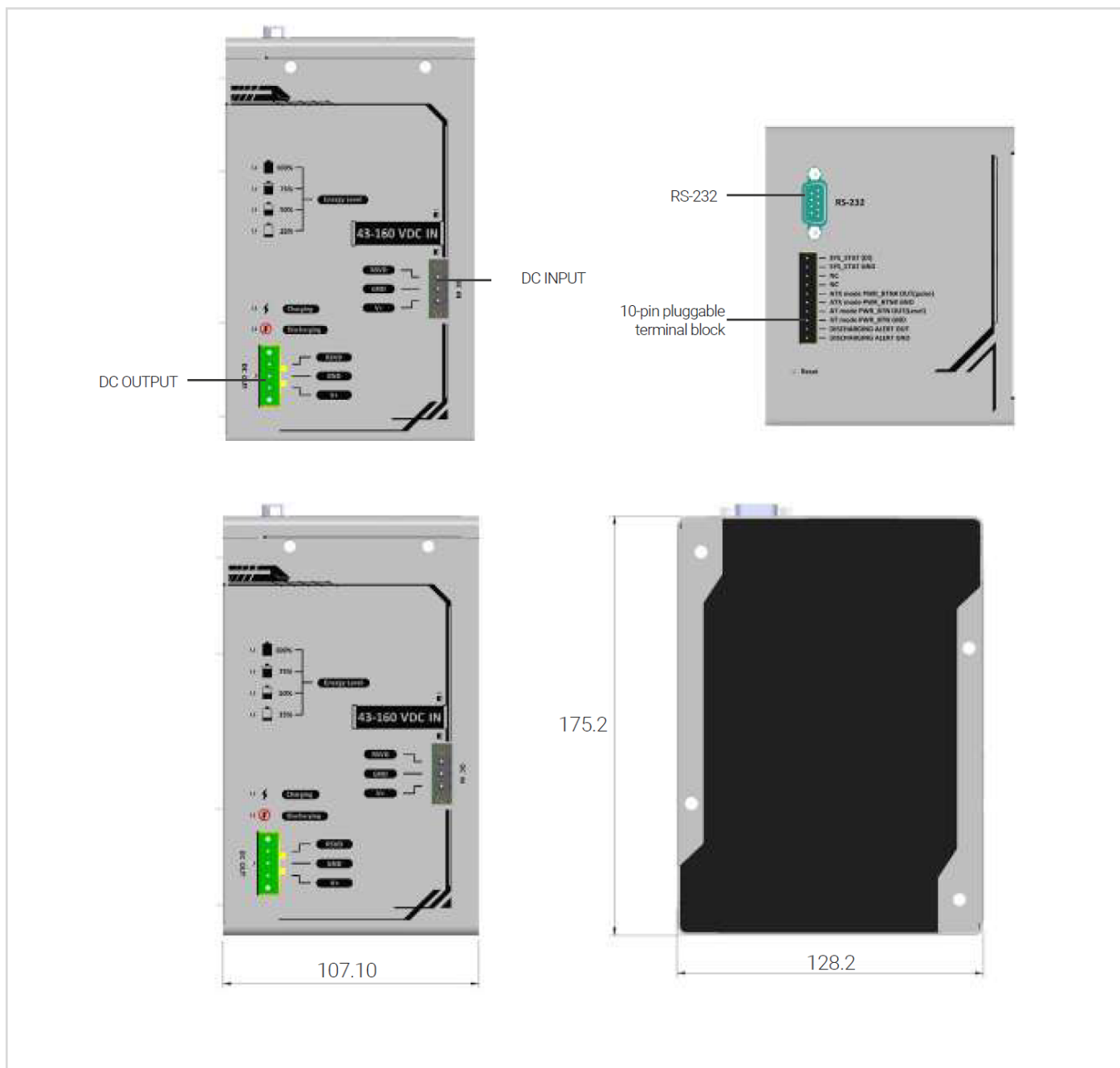

PB-9250J-110V

9250 watt seconds standalone supercapacitor-based UPS modul for railway applications

Ordering information

PB-9250J-110V

MODEL NO.

PB-9250J-110V

9250 w-s standalone supercapacitor-based UPS module with 110V DC input for railway application

OPTIONAL ACCESSORIES

Wmkit-V-PB9250J-110V

Wall-mount assembly for PB-9250J-110V, vertical type